

REPLACEMENT OF STANDISH ROAD (CR 1)
 BRIDGE OVER SEPERATOR BROOK
 PIN 7753.92 B.I.N. 3363270

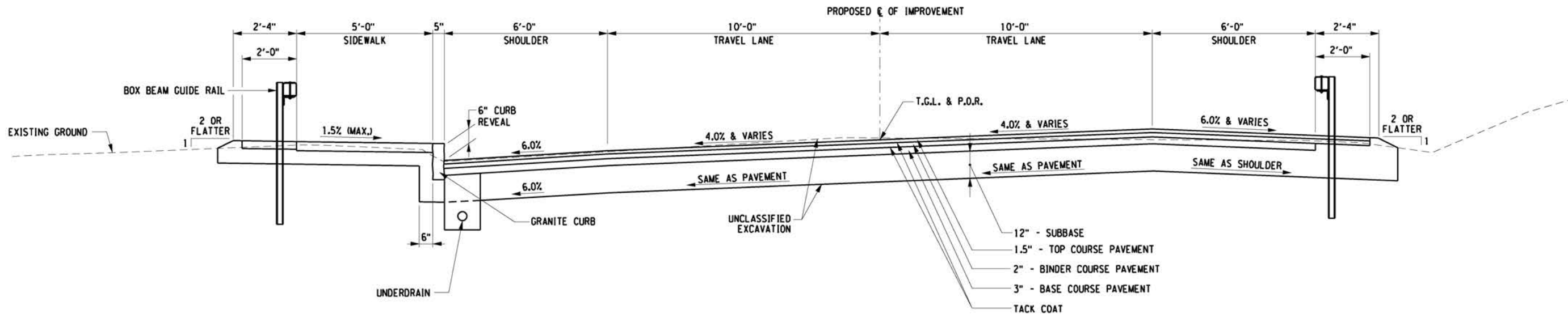

CLINTON COUNTY
 HIGHWAY DEPARTMENT





**TYPICAL HIGHWAY
RECONSTRUCTION SECTION**

LOCATIONS:
STA. 12+50.00 TO STA. 13+87.78
STA. 14+12.02 TO STA. 16+00.00

REPLACEMENT OF STANDISH ROAD (CR 1)
BRIDGE OVER SEPERATOR BROOK
PIN 7753.92 B.I.N. 3363270



CLINTON COUNTY
HIGHWAY DEPARTMENT



Department of
Transportation

**Barton
& Loguidice**

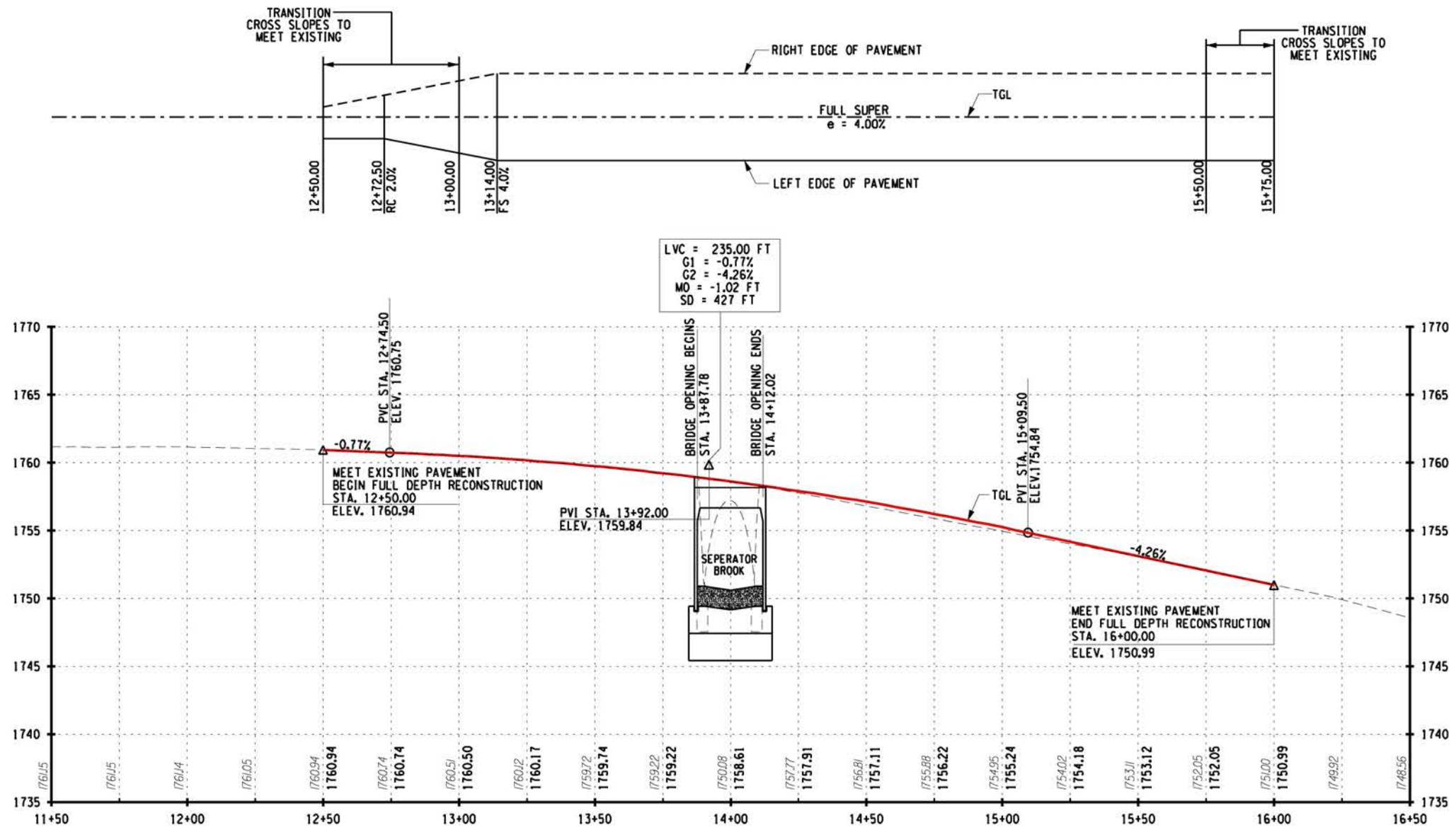

STANDISH ROAD (CR 1) PROFILE

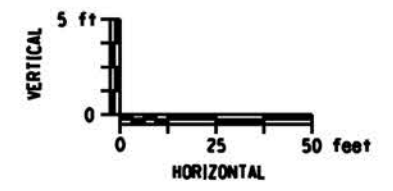

REPLACEMENT OF STANDISH ROAD (CR 1)
 BRIDGE OVER SEPERATOR BROOK
 PIN 7753.92 B.I.N. 3363270



CLINTON COUNTY
 HIGHWAY DEPARTMENT



GRID NORTH

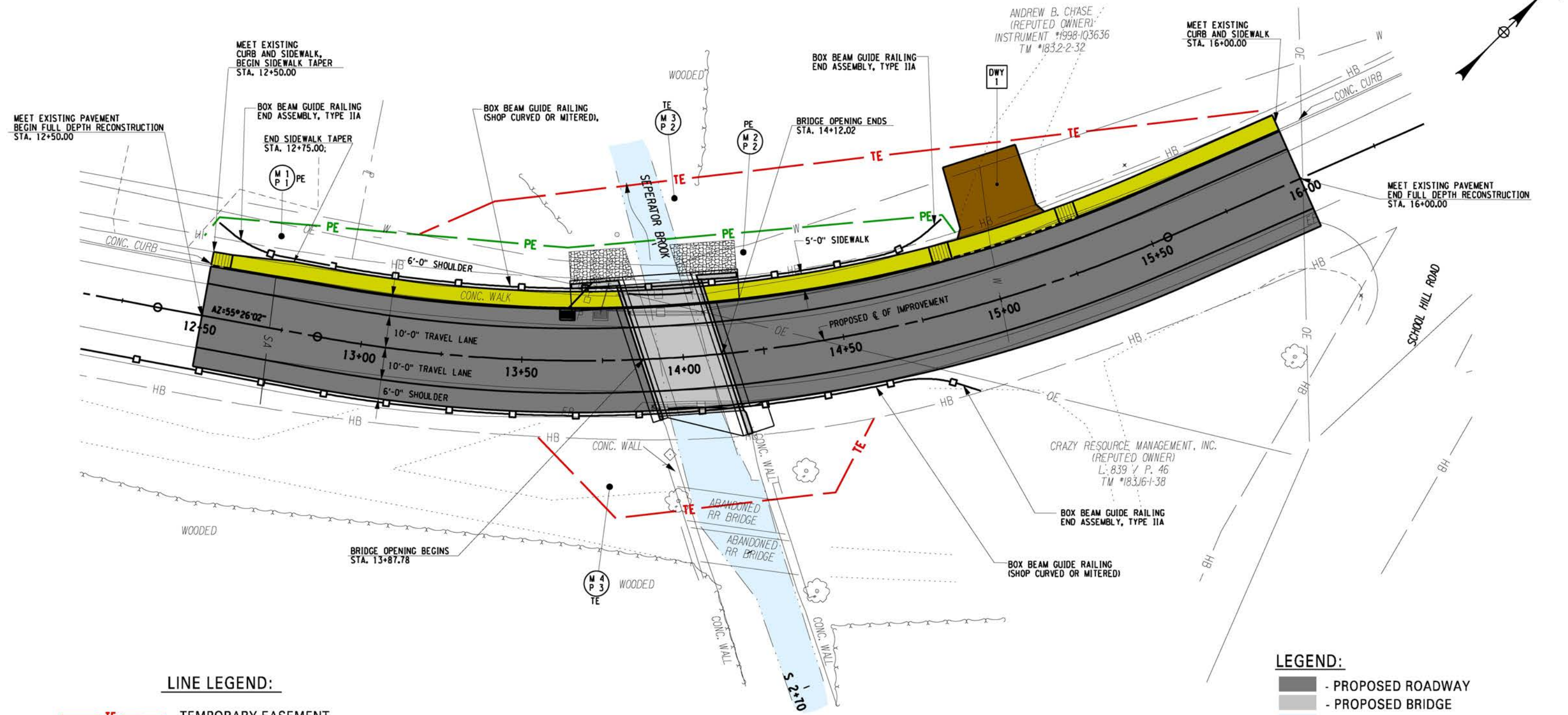

LINE LEGEND:

- TE — TEMPORARY EASEMENT
- PE — PROPOSED PERMANENT EASEMENT
- HB — EXISTING HIGHWAY EASEMENT

LEGEND:

- PROPOSED ROADWAY
- SEPERATOR BROOK
- DRIVEWAYS
- SIDEWALKS

REPLACEMENT OF STANDISH ROAD (CR 1)
BRIDGE OVER SEPERATOR BROOK
 PIN 7753.92 B.I.N. 3363270



CLINTON COUNTY
HIGHWAY DEPARTMENT



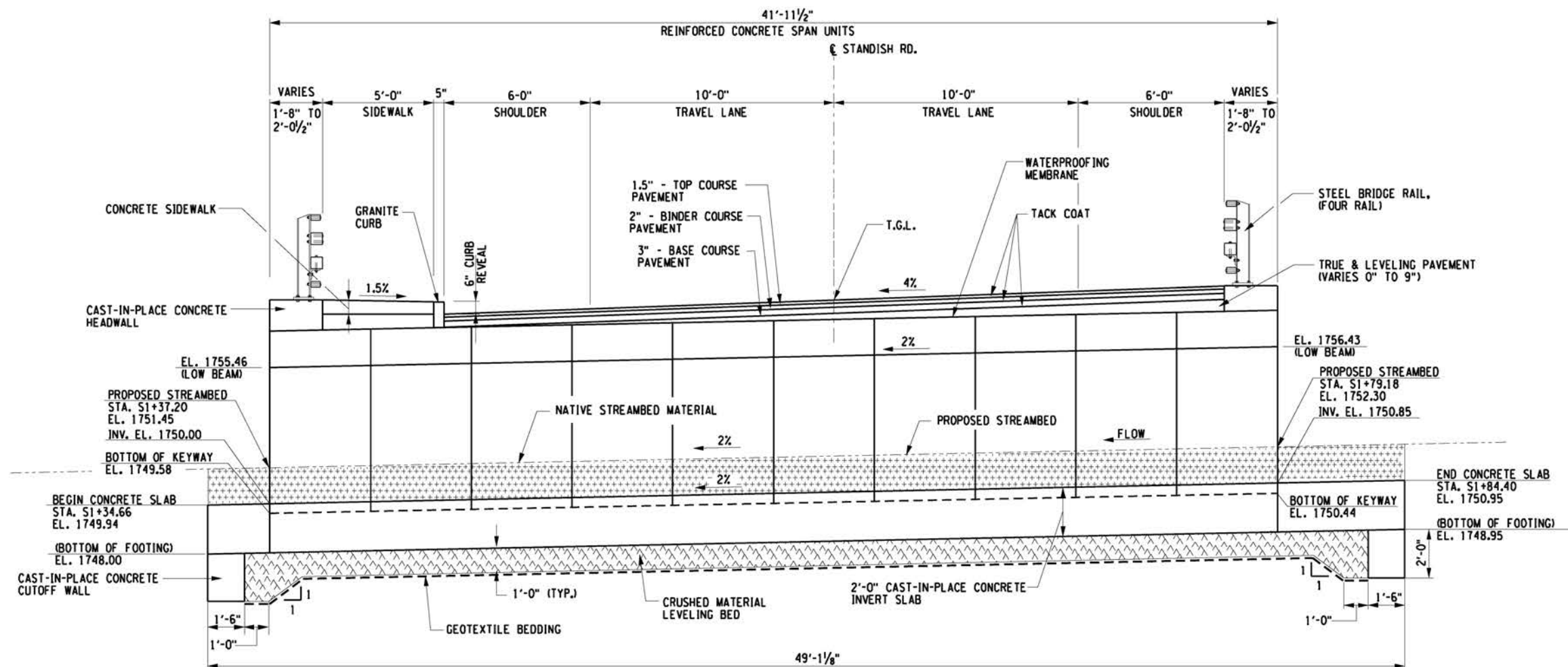

PROPOSED BRIDGE SECTION

REPLACEMENT OF STANDISH ROAD (CR 1)
 BRIDGE OVER SEPERATOR BROOK
 PIN 7753.92 B.I.N. 3363270



CLINTON COUNTY
 HIGHWAY DEPARTMENT



Department of
 Transportation



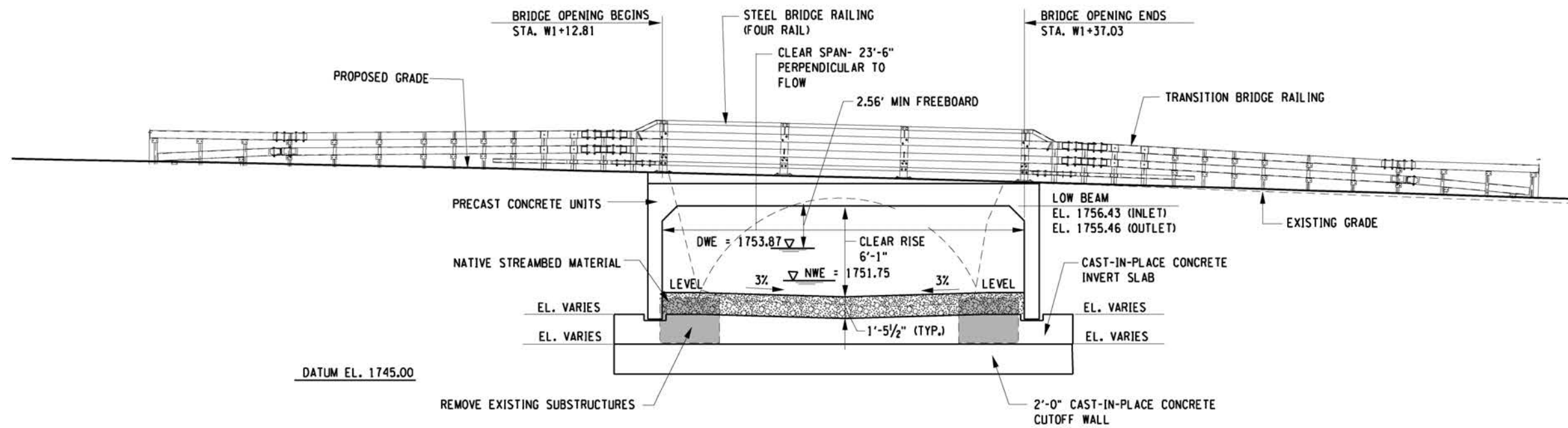

REPLACEMENT OF STANDISH ROAD (CR 1)
 BRIDGE OVER SEPERATOR BROOK
 PIN 7753.92 B.I.N. 3363270



CLINTON COUNTY
 HIGHWAY DEPARTMENT

